

Diplexer 2 VOR/2 GS • CI 1125

Frequency • 108-118 MHz & 329-335 MHz

Dual VOR/Dual GS diplexer features diplexer circuitry in a small die-stamped housing for high reliability. Provides operation between two VOR receivers and two glide slope receivers from the same VOR/GS antenna.



MODEL - CI 1125 Diplexer	
Electrical	
Frequency	108-118 MHz & 329-335 MHz
VSWR	1.5:1 Maximum
Isolation	20 dB between VOR/GS 18 dB between VOR Ports 18 dB between GS Ports
Insertion Loss	0.6 dB Maximum
Impedence	50 Ohms
Mechanical	
Weight	0.25 lbs
Height	0.75 inches
Material	Aluminum
Finish	Aluminum
Connector	BNC (Female)
Environmental	
N/A	Internal Mounting
Federal Specifications	
FAA TSO	C34c, C36c, C40a

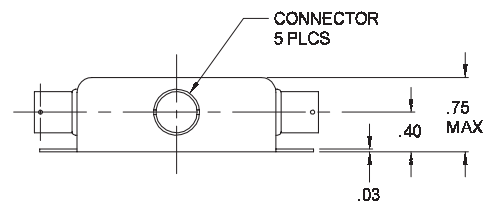
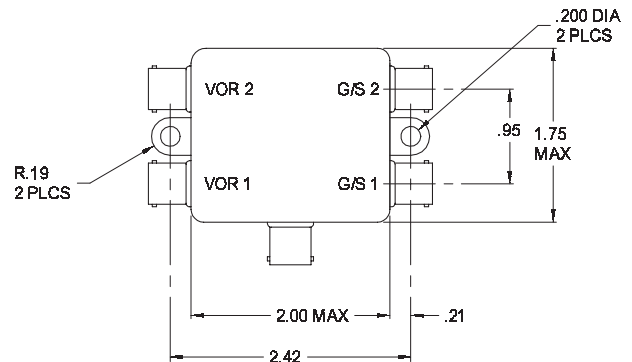

Warning: Drawing not to scale. Use factory supplied drawings and specifications for installation. Refer to FAA AC 43.13-2A for installation guidelines. © 2006 Comant Industries, Inc. Patented. Other Patents Pending.